

Wave12(1205/1210) User Manual

Hand Gesture Controller

BLE bluetooth-connected & Wireless Charging

Version 1.0

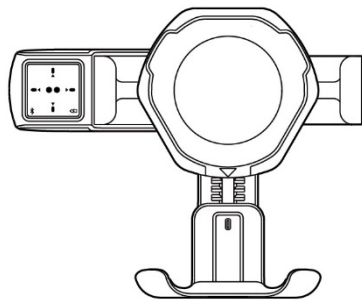

Introducing HPB Wave12

- Motion sensor and LED indicators
- Bluetooth indicator
- Wireless charging indicator

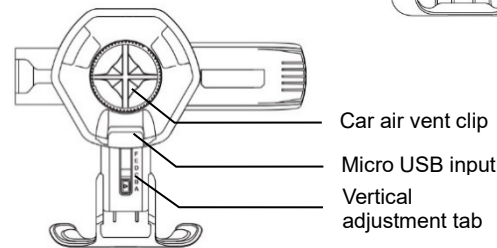

***Please do not place any material on charging PAD. Metal case mobile phone is forbidden on this device.**

Product Specifications

- Detection distance: 5~10 cm (from cover glass)
- Detection angle: 42 degrees (from center of sensor)
- BLE connection distance: Max. 6m
- Power Input micro USB: Wave1205 DC5V 1.7A; Wave1210 DC9V 2.1A (suggest use cigarette lighter receptacle with USB Type A connector)
- Cradle size (W/H/D): 129.1mm/105.8mm/74.4mm; Adjustable width: Min. 66.3mm, Max. 91.5mm; Adjustable height: 18.6mm;
- Wireless Charging Power: Wave 1205 : Output Power - 5W; Wave 1210 : Output Power - 10W
- BLE bluetooth Frequency : 2.4GHz
- Range of Working Temperature 0~40°C
- Caution : The rated output current of power adapter shall be as below: Wave 1205:5V/1.7A Wave 1210:9V/2.1A
- Wireless Charging Frequency : 110-205kHz

Package Contents

- HPB Wave12
- Micro USB cable
- User manual
- Car air vent clip

Disclaimer

The function to hang up phone by using hand gestures is not compatible with iPhone.

Install your Wave12

1. Locate the "T" shaped end of the clip
2. Match the "T" shape end with the opening on the back of the mount
3. Slide the clip in until an audible click is heard
4. Fix the Wave12 on a suitable location
5. Connect the cable to the micro USB input located on the back of the Wave12
6. Plug into the car using USB outlet or via a cigarette lighter with USB Type A connector (Cigarette lighter is not standard accessory)

Phone Placement for Wireless Charging

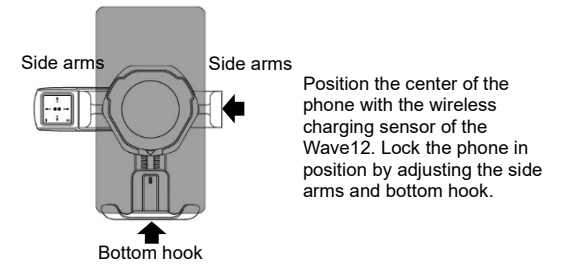

Light Indication Guide

The light indications are shown on the motion sensor panel on the left of the Wave12 device.

1. Bluetooth indicator (off): No phone connected; Bluetooth indicator (on): Phone is connected
2. Green battery indicator (on): Standby mode; Red battery indicator (on): Phone charging; Red battery indicator (blinking): Obstruction & Over current

Vertical Adjustment Guide

The vertical adjustment tab is located on the back of the Wave12. Gently push on the tab to slide the vertical adjustment up and down. Once the desired position is found, release the tab to set the position. There are 7 different adjustable positions (drawing as below).

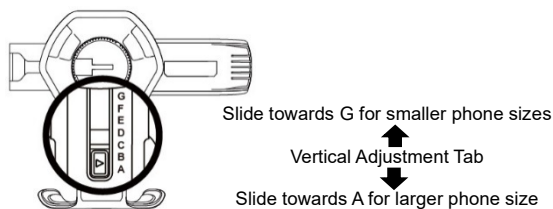

Attention

This device is designed to work with your Smart phone and bluetooth-enabled car stereo or bluetooth-enabled speakers. Please check the connection before use. The function to hang up phone using hand gestures is not compatible with iPhone.

For iPhone (No APP is needed)

*Support iOS 10.0 and above

Car Audio Routing Setting

To set up your phone, go to Settings>General>Accessibility>Call Audio Routing, select "Bluetooth Headset".

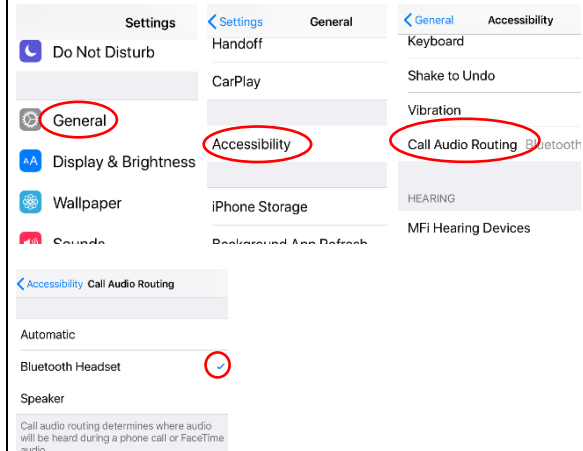

BLE bluetooth-pairing

1. Go to Settings of your iPhone and turn on "Bluetooth". iOS system will scan devices automatically. At "Other devices" you may find several bluetooth-connected devices, select "Wave12-xxxx".
2. System will pop out a pair request dialog box and choose "Pair". Wave12 will be paired and connected. Blue LED will be on.
3. Please double check the "Bluetooth", "Wave12-xxxx" is connected in your "My Devices" list.

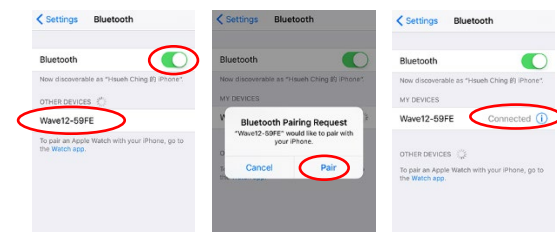

For Android Phone (Please download APP "HPB WAVE" before using)

*Support Android 6.0 and above

Install APP & Related Settings

Scan the QR code below or go to your "Play Store" for "HPB WAVE" APP installation.

1. Upon completion, click "Yes" to turn on "Bluetooth".
2. In the "Settings>Sound & Notification>Notification access", select "hpb wave".
3. In the "Settings>Accessibility", turn hpb wave to "ON".

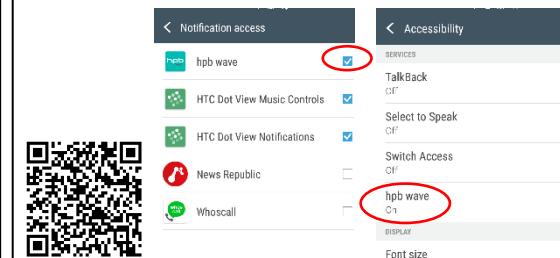

For Android user : if you have several bluetooth-connected speakers, you must choose one of them.

BLE bluetooth-pairing

Start hpb wave APP. Click on "Connection Setting" to search for available device "Wave12-xxxx" and select it.

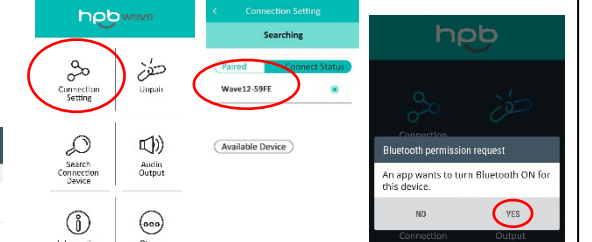

More functions on hpb wave App:

- Unpair: To remove the device, click "unpair".
- Search Connection: Click to search available device nearby. If yes, you will see "Wave12-xxxx is connected!".
- Audio Output: There are options for your choice. "Mobile Phone": audio out from your mobile phone "Mobile Speakerphone (voice only)": audio out from your mobile phone speaker "Other devices": It will go to phone system to allow you to connect your target BT devices.

Operation instructions

Wave hand in front of the motion sensor from position 1 to 2 0.5~1 second

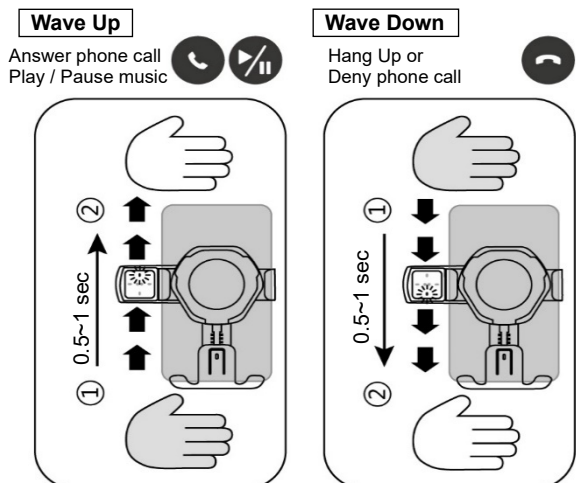

Operation instructions

Wave hand in front of the motion sensor from position 1 to 2 within 0.5~1 second

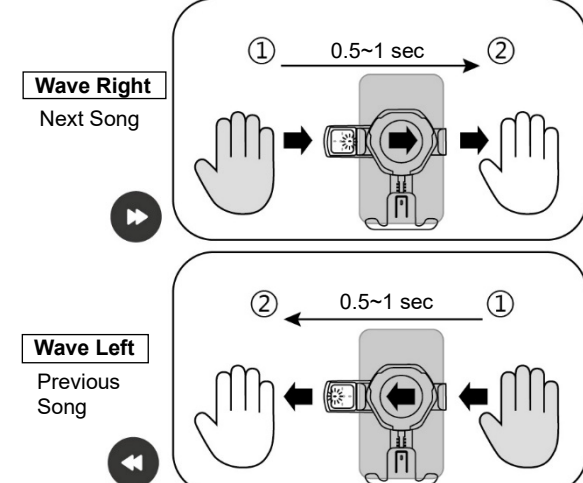

Operation instructions

Wave hand in front of the motion sensor from position 1 to 2 within 0.5~1 second

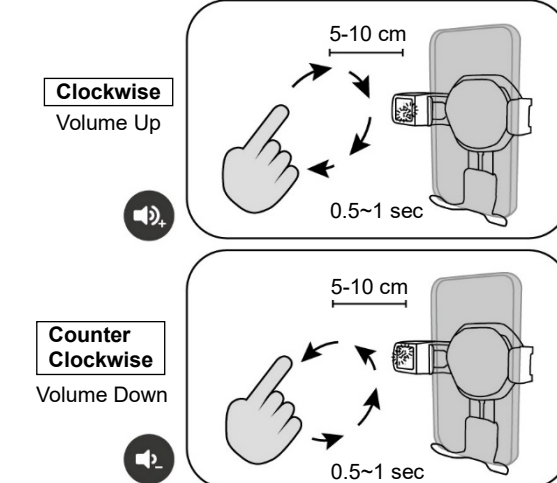

Hereby · HPB HI-TECH CORP. declares that the radio equipment type [Wave 12 designation of type of RE] is in compliance with Directive 2014/53/EU. The full text of the EU declaration of conformity is available at the following internet address: 10F., No.308 Sec. 1, Neihu Rd, Taipei, Taiwan, R.O.C.

Federal Communication Commission Interference Statement

This equipment has been tested and found to comply with the limits for a Class B digital device, pursuant to Part 15 of the FCC Rules. These limits are designed to provide reasonable protection against harmful interference in a residential installation. This equipment generates, uses, and can radiate radio frequency energy and, if not installed and used in accordance with the instructions, may cause harmful interference to radio communications. However, there is no guarantee that interference will not occur in a particular installation. If this equipment does cause harmful interference to radio or television reception, which can be determined by turning the equipment off and on, the user is encouraged to try to correct the interference by one or more of the following measures:

- Reorient or relocate the receiving antenna.
- Increase the separation between the equipment and receiver.
- Connect the equipment into an outlet on a circuit different from that to which the receiver is connected.
- Consult the dealer or an experienced radio/TV technician for help.

FCC Caution:

This device complies with Part 15 of the FCC Rules. Operation is subject to the following two conditions: (1) This device may not cause harmful interference, and (2) this device must accept any interference received, including interference that may cause undesired operation. Changes or modifications not expressly approved by the party responsible for compliance could void the user's authority to operate the equipment.

FCC Radiation Exposure Statement:

This equipment complies with FCC radiation exposure limits set forth for an uncontrolled environment. This equipment should be installed and operated with minimum distance 20cm between the radiator & your body.

Warranty Card

This Limited Warranty is certified that HPB HI-TECH CORP. is guaranteed for free repairs up to 12 months from the date of purchase against assembly / manufacturing faults. This warranty does not cover defects resulting from improper or unreasonable use or maintenance; failure to follow operating instructions; accident; excess moisture; insects; lightning; power surges; connections to improper voltage supply; unauthorized alteration or modification of original condition; damages caused by inadequate packing or shipping procedures; loss of, damage to or corruption of stored data; product that requires modification or adaptation to enable it to operate in any country other than the country for which it was designed, manufactured, approved and/or authorized, or repair of products damaged by these modifications; and products purchased from unauthorized dealers. This warranty period is effective from 30 days after manufacture month if the warranty card is illegible, removed, altered or damaged. HPB or HPB authorized distributor will provide quotation to consumer first for any service demand exceed warranty period. Service demand will conduct after received consumer agreement.

Seal:	Date of Purchase:
-------	-------------------

Maintenance & Service

H.P.B. Hi-Tech Corp.
10F., No.308 Sec. 1, Neihu Rd, Taipei, Taiwan, R.O.C. Tel: 886-2-26581566
Customer Service Hotline: 886-2-26581566 Email: service@hpbhitech.com

